

CopyIt

The Grid Drawing
Method for iOS



Copyright © 2010-2015 Nigel Green.

All rights reserved.

Apple, the Apple logo, iPod, iPod touch, iPhone, iPad and iTunes are trademarks of Apple Inc., registered in the U.S. and other countries. App Store is a service mark of Apple Inc.

Acknowledgements

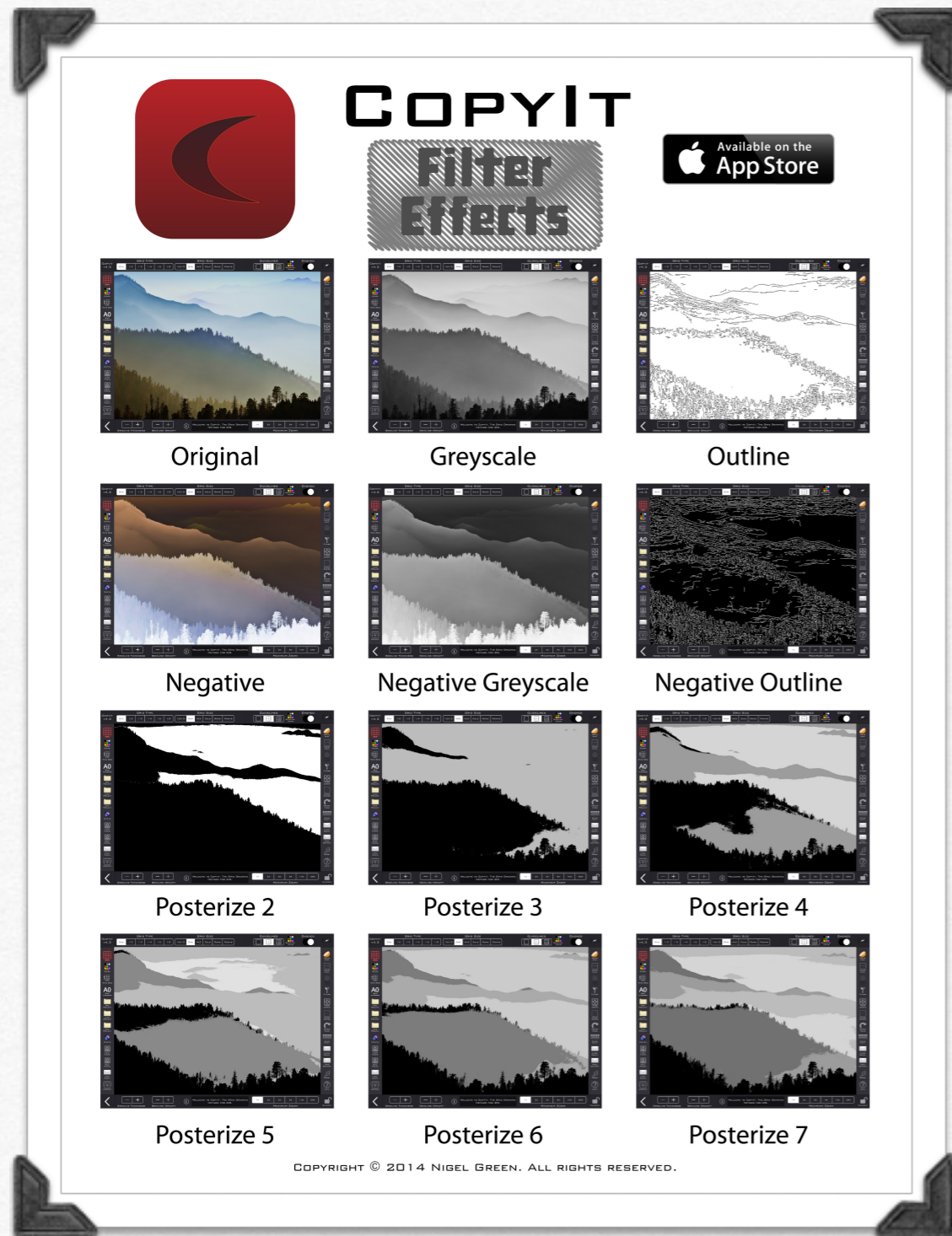

To my best friend and soul mate, my darling wife Elizabeth, thank you for your patience, love and support. I am blessed to be able to share my life with you.

Thanks also to the many users of CopyIt who have provided feedback and new feature suggestions.

Your App Store reviews are appreciated and encourage me to keep the updates coming.

Thank you for your support and I hope you continue to enjoy using CopyIt as much as I do.

Foreword

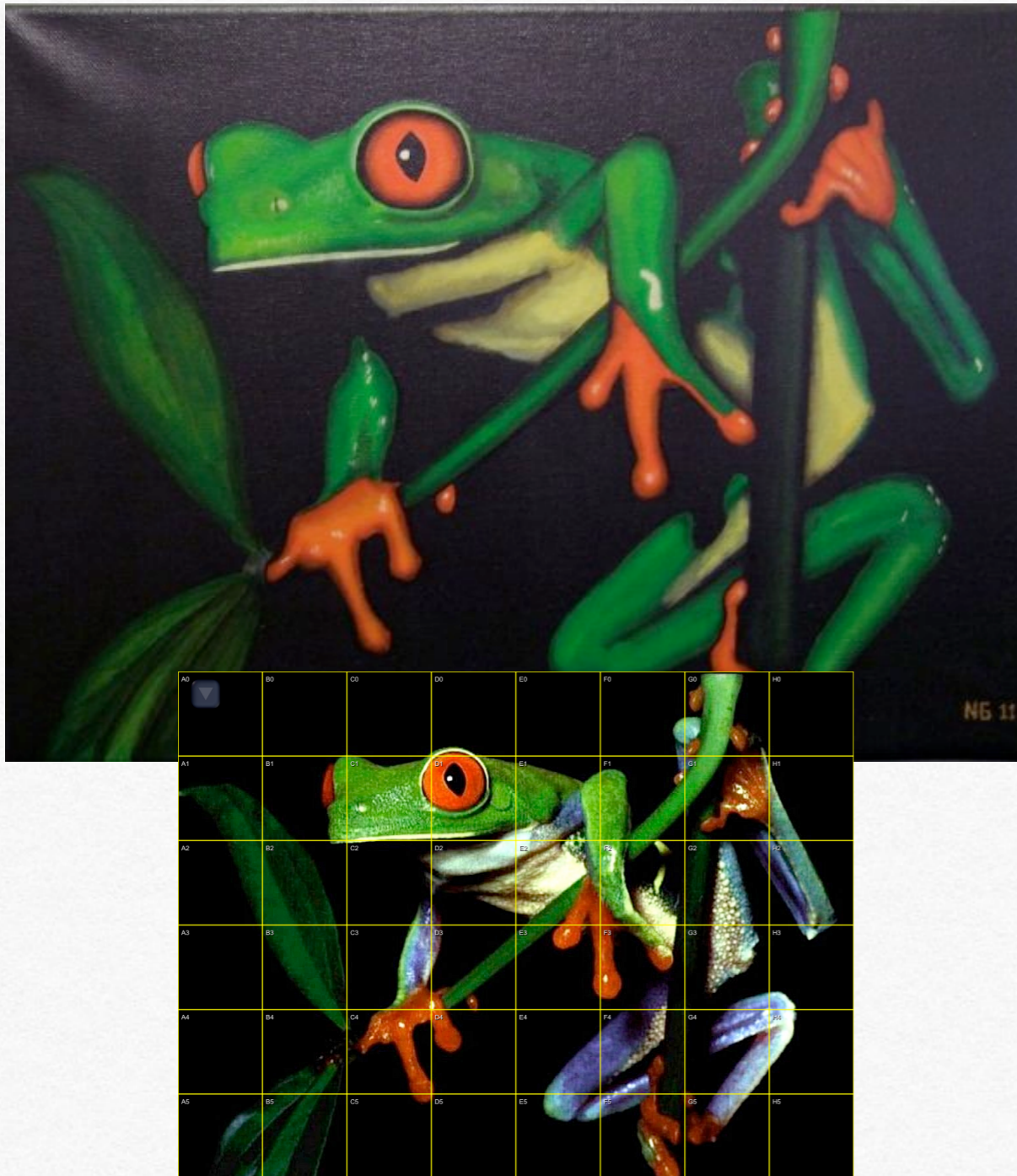

TREE FROG - ACRYLIC - PAINTED WITH THE AID OF COPYIT USING A GRID SETTING OF 8X6 SQUARES ON AN IPAD.

Loving to draw since early childhood, I first used the Grid Drawing Method in art class at primary school.

Over the years I have found it an invaluable tool for both drawing and painting.

With the introduction of the iPad on January 27th, 2010 I soon saw the potential of the device to be used for artistic purposes due to its portability and large high resolution screen.

I had already released a few Apps on the iPhone and iPod touch by this time, so I had the knowledge and ability to jump right into creating a Grid Drawing App. Initially for the iPad only, CopyIt for iPad v1.0 was released in June 2010. The Universal version of CopyIt v1.3 followed later and was released in November 2010.

Since its initial release, CopyIt continues to this day to be the most feature-packed and useful Grid Drawing App available on the App Store.

CopyIt

THE GRID DRAWING METHOD FOR IOS

COPYIT ASSISTS YOU IN COPYING, ENLARGING OR REDUCING YOUR CHOSEN REFERENCE IMAGE USING THE GRID DRAWING METHOD. IT IS AVAILABLE FOR IPAD, IPHONE AND IPOD TOUCH ON THE APP STORE.



The image shows the CopyIt app interface on a tablet. At the top, the app's logo consists of a red square with a white crescent shape inside, followed by the word "COPYIT" in a bold, black, sans-serif font. Below the logo, the text "THE GRID DRAWING METHOD FOR IOS" is displayed in a smaller, black, sans-serif font. The main part of the interface shows a tiger's face with a grid overlaid on it. The grid is composed of small squares, and the tiger's features are being traced onto it. To the right of the grid, there is a larger, stylized drawing of the tiger's face, showing the result of the grid drawing method. The interface also includes various control buttons and a toolbar on the left and bottom edges.

WWW.NIGELGREENSAPPS.COM
COPYRIGHT © 2014 NIGEL GREEN.

Available on the App Store

DISCOVER THE ARTIST WITHIN YOU.

What is the Grid Drawing Method?

The humble Grid Drawing Method has been around for a long time.

Throughout history artists were using it to aid them in keeping their proportions correct as they copied their subject.

The ancient Egyptians at the beginning of the Middle Kingdom (around 2055 BC - 1650 BC) used it by 'snapping' a string soaked in red dye against a wall to create the grid lines.

Renaissance artists would build a wooden frame, hammer in nails spaced equally apart and tie lengths of string from one end to the other to create their rows and columns.

HAVE AROUND 4000 CANDLES HANDY IF YOU EVER WANT TO GET THE GRID DRAWING METHOD A BIRTHDAY CAKE!

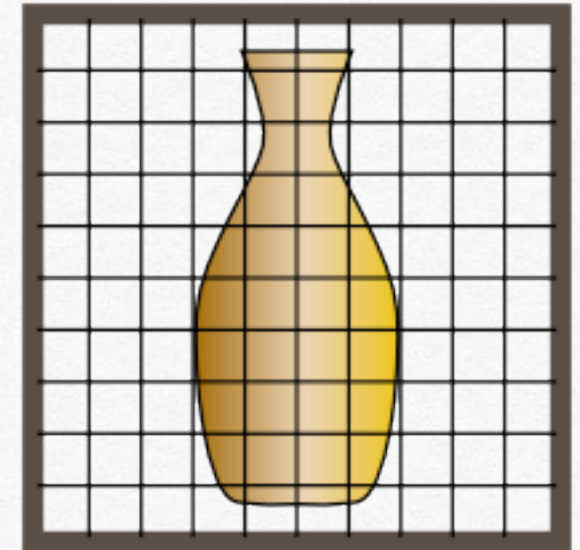
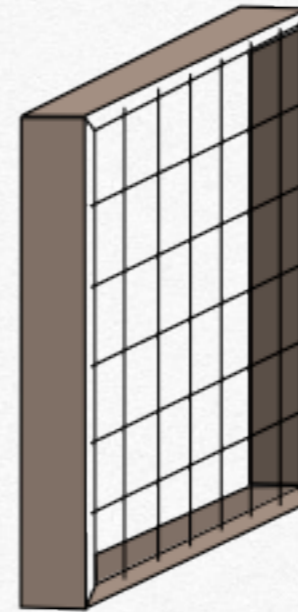

They would then place the wooden frame where they could look through the grid and see their subject from where they would begin work.

More recently, The Grid Drawing Method evolved to where artists would print out a photo and draw their grid directly onto the photo or overlay it with transparent film.

Now with the availability of devices such as the iPad, iPhone and iPod touch, **CopyIt** supersedes all these methods and allows the artist to do more than ever previously possible.

SINCE IT'S INITIAL RELEASE IN 2010, COPYIT CONTINUES TO BE THE MOST ADVANCED GRID DRAWING APP AVAILABLE ON THE APP STORE!

Features

Features	
Universal App, compatible with iPad, iPhone and iPod touch	Export to Photo Album and email
Supports Retina and larger iPhone displays	Front and back Camera support
Fullscreen mode	Change Grid Transparency and Grid Line thickness
12 Primary Filter Effects, 6 Secondary Filter Effects	Solid or dashed Guidelines
6 Grid types: Square Grid, 1/2, 1/3, 1/4, 1/6, 1/8 rectangular grids	Choose from 9 guideline colors (separate to grid color)
Set your Maximum Zoom level from x1 to x20	Rotate the image in 90 degree increments
Choose from 9 grid colors, Black (default), Gray, White, Red, Green, Blue, Yellow, Orange and Magenta.	Audible feedback
Print directly to AirPrint compatible printers	Load, Save and Delete Projects
Grid letters and numbers	12 different image aspects
Touch a grid square to move your focus with SmartMove™	Battery meter on toolbar
Diagonal Cross Guides	Settings App Options
Used in conjunction with SmartMove™, Target mode highlights the current grid square and dims out the rest	Toggle center point to each grid square On/Off
Integrated Music Player so you can listen to music while you work	Toggle “Keep Device Awake” On/Off
Preset Grids for iPad: 16x12, 8x6 and 4x3 equal squares	Change Target Mode Transparency and color in the Settings App
Preset Grids for iPhone and iPod touch: 12x8, 6x4 and 3x2 equal squares	Toggle camera preview for grid overlay On/Off
Move the grid independently over the image	Change the background color to black, white or transparent

Interface

Wireless Printing



You can print what is on the display at any time to any AirPrint compatible printer. The toolbar will not be printed - but everything else you see will. This allows you to include in your printouts, grid letters and numbers, zoomed in details, grid colors and even the effects of Target Mode are printable.

Save To Photo Album



If you do not have an AirPrint compatible printer or you would like to use a third-party program with CopyIt, you can export your current project to the Photo Album on your device.

Please Note: To avoid any possible confusion if you accidentally re-load an image into CopyIt that has previously been exported, a small note is inserted at the bottom of any image saved to the Photo Album.

[“Exported by CopyIt. Importing this image into CopyIt may result in compounded effects.”](#)

This was deemed necessary because if you export an image with a grid setting of 8x6 and re-load it back into CopyIt and change your grid settings to something else, you will see a combination of two grids, one you can change and the other that is now part of the image.

You will need to reload your original image if you wish to change any settings that were exported with your image.

Grid Size

Due to the different aspect ratios of iOS devices, the grid presets are also different.



Device (Aspect Ratio)	Grid Size (Equal Squares)	Grid Size (Points)	Grid Size (Points)
iPad, iPad mini (1.33333:1)	16x12 (192 equal squares)	12x8 (96 equal squares)	14.2x8
iPhone 4S, iPod touch (1.5:1)	8x6 (48 equal squares)	6x4 (24 equal squares)	7.1x4
iPhone 5, iPhone 5S (1.775:1)	4x3 (12 equal squares)	3x2 (6 equal squares)	3.55x2
iPhone 6 (1.778667:1), iPhone 6 Plus (1.777778:1)			3.56x2

Columns: You can specify how many columns you want and the number of rows are automatically calculated. The number of columns can be entered up to 2 decimal places. e.g. 6.50 will be taken as six and a half columns.

Rows: You can specify how many rows you want and the number of columns are automatically calculated. The number of rows can be entered up to 2 decimal places. e.g 4.25 will be taken as four and a quarter rows.

Points: You can specify the grid square size using the number of points. Columns and rows are automatically calculated. Points can be entered up to 2 decimal places.

HANDY TIP: CHANGING BETWEEN COLUMNS, ROWS AND PIXELS WILL ALSO SHOW YOU HOW MANY COLUMNS, ROWS AND PIXELS ARE CURRENTLY BEING DISPLAYED BY THE CURRENT GRID.

SmartMove™



Use of this feature is optional.

By not using this feature, you can continue navigating around the grid as you would have in the previous versions of CopyIt (by scrolling and zooming with gestures).

When SmartMove™ is enabled and your maximum zoom is set to more than 1x, it allows you to navigate around the grid squares just by touching them. When using SmartMove™, your maximum zoom setting is important, as it controls how much it will zoom into each square when touched. If you are doing detailed work, then setting a higher maximum zoom is recommended however SmartMove™ will not zoom in on the grid square beyond the height of the display. If you require to zoom in beyond this point, you will need to use the zoom gesture.

Note: If your maximum zoom is set to 1x, touching a grid square when using SmartMove™ will seem to have no effect (as the whole grid will be visible).



SmartMove™ With Target Mode

Use of this feature is optional but it must work in conjunction with SmartMove™.

To further assist your focus while you work, Target Mode highlights the last grid square you touched and dims out all other squares.



Grid Letters And Numbers

Use of this feature is optional.

When enabled this allocates grid letters and numbers to all grid squares in the format of A0.

You can use this feature to keep track of where you are when working on larger drawings and paintings.

Guidelines



Use of this feature is optional and provides a choice of no guidelines, 1/4 and 1/16 guidelines within each grid square. Using guidelines can help you keep your drawing accurate as you copy your subject.

Guideline Color



9 guideline colors are available and can be set independently to the grid color.

Dashed Guidelines

If guidelines are in use you can switch between solid or dashed guidelines using this option.

Outline Threshold

When using either the Outline or Negative Outline filters, this controls how much detail there is when tracing the outline. The threshold ranges are 0.60 to 0.90

Handy Tip: for speed, temporarily turn off the outline filter, change the outline threshold to the desired amount, then re-select the outline filter.

Onion Skin



Onion Skin adds a transparent outline of the source image to the live camera preview. While active, you can adjust the transparency and detail of the overlay. Looking through the device and moving it closer or further away, you can line up the overlay to your work and quickly assess its accuracy. This feature requires a source image to be loaded first.

Cross Guides



You can optionally subdivide the grid using diagonal lines for additional guidance. Cross Guides can be used with or without Guidelines and share the current Guideline color.



Locked Mode

Locked Mode prevents any unwanted adjustments. While enabled, the only active buttons are Fullscreen Mode and Unlocked Mode.



Unlocked Mode

Unlocked Mode enables all available features for normal use.



Move Grid

The Move Grid option allows you to move the grid independently over the top of the image.

Turn this off again to lock it into place.



Toggle Grid

This will toggle the display of the grid.

If the grid is turned off, some functions that require the grid will be unavailable.

Turning on the grid will make these functions available again.



Load From Photo Album

Loads a reference image from your Photo Album.



New Project

Upon confirmation, this will reset all CopyIt settings and unload the current image.



Load Project

Loads a previously saved project, replacing the current one.

To delete a project, double-tap the delete button beside the project you wish to delete.

REMEMBER TO SAVE YOUR CURRENT PROJECT BEFORE LOADING ANOTHER ONE IF YOU NEED TO.



Save Project

Saves the current project. CopyIt does not overwrite existing projects. Each time you save a project, another version is saved.

Maximum Zoom Settings



Using the preset maximum zoom settings allows you to restrict how

much you can zoom into your reference image.

The available zoom settings are: 1x, 2x, 3x, 5x, 10x and 20x.

These settings are especially useful when used in conjunction with SmartMove™

Grid Colors



9 grid colors are available to switch to at anytime, allowing the grid to remain visible for any colored reference image.

Hide Toolbar (Fullscreen Mode)



This allows you to hide the toolbar and work unobstructed.

Show Toolbar



This will show the toolbar so that you can change CopyIt settings again.

Filter Effects



12 Primary Filters are available.

- Original
- Greyscale
- Outline
- Negative
- Negative Greyscale
- Negative Outline
- Posterize 2-7

6 Secondary Filters are available.

- Less Exposure
- More Exposure
- Blur
- Sharpen
- Less Vibrant
- More Vibrant

Secondary Filters are those that can be applied to the original Primary Filters (Original, Greyscale, Negative etc) and will accumulate their effect.

Note however, selecting a new Primary Filter will remove all currently accumulated Secondary Filters.

Rotate Image



Rotate the reference image clockwise in 90 degree increments.

Email



An alternative to printing or saving to your Photo Album, this will export your current project as a .png image file and insert it as an attachment in a blank email.

All you need to do is choose an email address from your address book or type one into the To box and hit send!

Camera



If your device has a camera, this button will be visible. Use this to capture an image to use as your reference image.

Both front and back cameras are supported.

Grid Transparency



This allows you to set your grid transparency from 5% to 100% in 5% increments. If guidelines are being used they will be included in this setting.

Line Thickness



There are 5 different line thickness settings available.

1, 3, 5, 7 and 9.

Image Aspect



There are 12 different aspects available.

Although the iPad screen uses a ratio of 4:3 and the iPhone and iPod touch use 3:2, you can use any image ratio by using the **Aspect Fit** setting.

Example: Using the Photos App, crop any image to 16x9. After choosing this cropped image from your Photo Album from within CopyIt, choose **Aspect Fit** from the Image Aspect options.

This will ensure your image will maintain the 16x9 aspect. Choosing anything else will most likely stretch the image to fit the screen or in some other way not look how you expect it to.

It will now have blank space above and below your image - a bit like a wide-screen movie on a 4:3 television.

After you do this, you may then want to use the Move Grid option to place the top left corner of the grid at the top left corner of your image.

Music Player



Listen to your favourite tunes with the in-built music player. Add songs to your playlist from your iTunes music library, without leaving CopyIt.

Music volume is controlled using the device volume controls.

Note: Requires access to your music library to function.

Settings App Options

There are additional CopyIt settings that can be changed outside of the CopyIt App which are within the Settings App on your device.

Sound

Toggle the button sounds on/off.

Maximum Email Attachment 1MB-10MB

Devices with the Retina display will export images at double the normal size.

If you are concerned with how large your CopyIt email attachments might get, you can set a preferred limit between 1MB - 10MB. If an attachment exceeds this limit, you will be notified before the image is attached and asked if you would like to try to reduce its size or continue. If the image size is reduced, some images may still exceed this preferred limit, depending on the complexity of the image. (To maintain image quality, no image will ever be smaller in dimension than the device screen it is displayed on.)

Keep Device Awake

Active by default, this prevents the screen from dimming and turning off (if power-saving features are being used). This allows you to work for extended periods uninterrupted. You can turn this option off if you wish to preserve battery power.

'Exported By CopyIt' Watermark

You have the option to remove the watermark from images exported to the Photo Album. Leaving this option on will help you to determine if an image has previously been exported by CopyIt and therefore may contain embedded settings (e.g. grid or filter effects).

If you decide to turn this off, remember to keep this in mind if re-importing exported CopyIt images.

Center Dot

Adds a dot to the center of each grid square as a visual aid.

Background Color

You can change the background color of your image to black, white or transparent. This background color is then used by all the export options. For best results, your imported images should have transparent backgrounds also.

Grid Number Formats

- A0, B0, C0... (Original)
 - 0A, 0B, 0C...
 - A0, A1, A2...
 - 0A, 1A, 2A...
-

Target Mode Transparency

Controls the transparency of the 'dimmed out' grid squares when using SmartMove™ and Target Mode.

Target Mode Color

You can choose between black or white Target Mode colors.

Preview Grid Overlay

If your device has a camera, you can see your current grid settings displayed as an overlay during the live preview when taking a photo as your reference image.

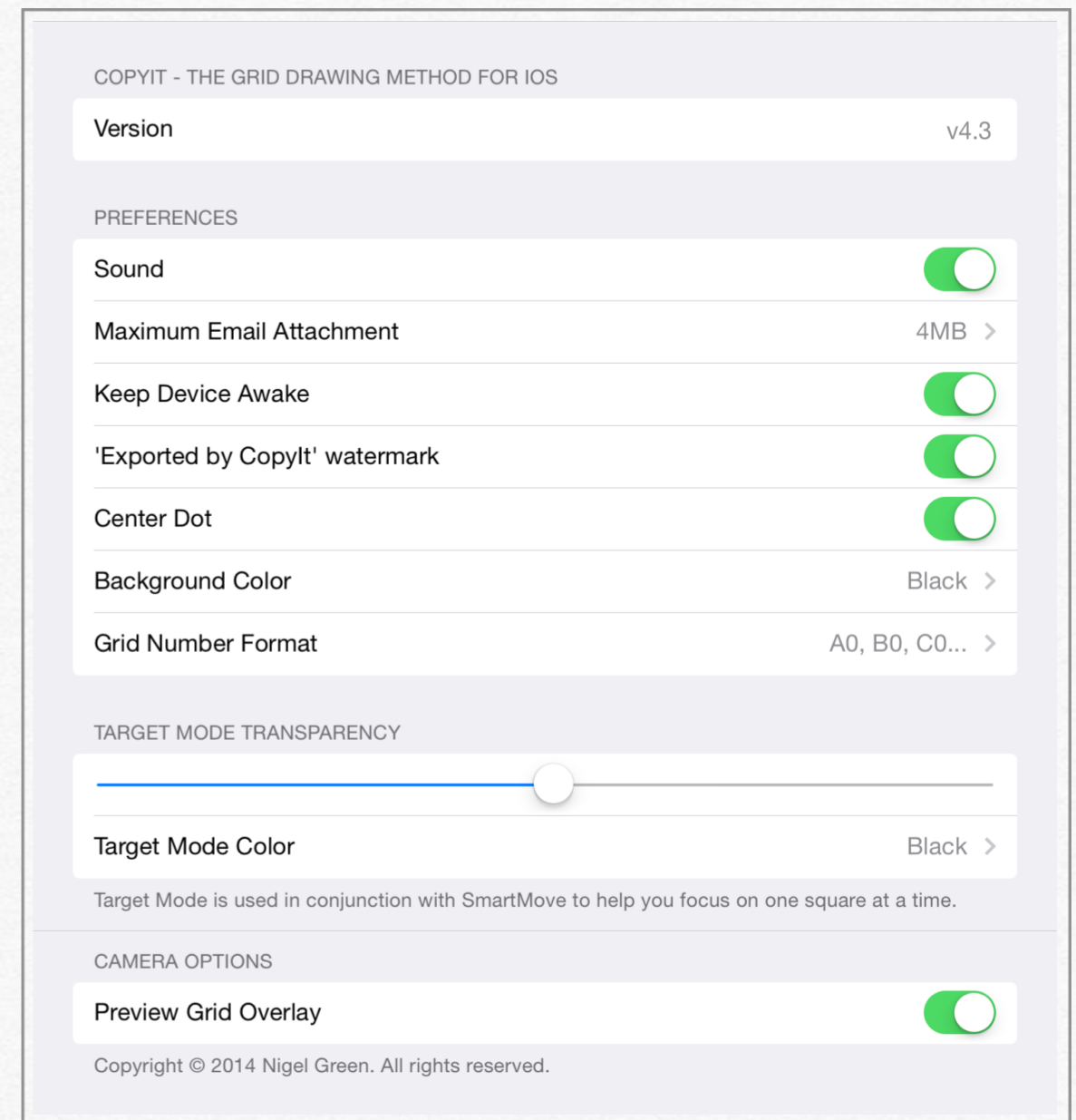

Support Website:

www.nigelgreensapps.com/copyit.php

[Follow CopyIt On Twitter](#)

[Follow CopyIt On Facebook](#)

[Download CopyIt now from the App Store!](#)

Other CopyIt titles available on the App Store:

[CopyIt Legacy](#)

[CopyIt Classic](#)

[CopyIt for Kids](#)

"If you find CopyIt useful then please spread the word with a review of CopyIt on your local App Store. It's quick and easy to do and it gives me a great motivational boost to keep those updates and new features coming!" - Nigel Green



**CopyIt - The Grid Drawing
Method for iOS**